

# 2022 TRADITIONAL ARTS RESEARCH RESIDENCY AT STAMFORD ARTS CENTRE

## ABOUT TRADITIONAL ARTS RESEARCH RESIDENCY

### ABOUT THE TRADITIONAL ARTS RESEARCH RESIDENCY

The Traditional Arts Research Residency aims to support artists and academics/researchers to jointly collaborate on practice-based research and/ or documentation initiatives relating to traditional performing art forms.<sup>1</sup>

The 16-week Traditional Arts Research Residency should be completed within the period of 1 April to 30 September 2022.

The proposed project should focus on at least one of the following themes\*:

- Documentation and analysis of distinctive practices in the chosen traditional art form(s);
- Research and artform exploration for the development of new creative works; and/or
- Research and discourse on cross-cultural exchanges of traditional performing art forms in Singapore.

*\*Funding is prioritised towards proposals with strong use of digital technology as part of the research and creation process, and/or proposals with a long-term impact the artistic excellence and development of the relevant traditional art form(s).*

Only joint applications between Singapore-based artists and academics/researchers will be considered for the Residency. The Residency will receive **one** artist and researcher-in-residence for the above-mentioned period. A space will be provided for successful applicants to facilitate dialogue and discussion on the project topic. The Residency should result in at least two public presentations during the period of residency.

The artist and researcher-in-residence will have the opportunity to tap into the network of traditional arts groups housed in SAC and are encouraged to carry out exchanges with these arts groups. Situated in the vibrant and dynamic district of the Waterloo Arts Belt, this Residency also offers proximity to the rich repository of resources in the National Library and arts institutions like the Nanyang Academy of Fine Arts and LaSalle College of Arts.

*Artists or arts collectives interested in incubating new and innovative content with a traditional performing arts focus should refer to the other set of information on 2022 Traditional Arts Residency at Stamford Arts Centre.*

### A NOTE ON ETHICS, INTELLECTUAL PROPERTY (IP) AND EXPLOITATION OF FINDINGS

- Researchers from institutions of higher learning should obtain endorsement for the proposed research project from the project supervisor or head of department. Independent researchers should provide a referee or document of support from relevant sources or institutions, where applicable.
- If the project involves human participants or the use of potentially sensitive economic, social or personal data, you must have obtained clearance from an Institutional Review Board (IRB). If you

---

<sup>1</sup> For a list of recognised traditional arts practices please contact Valerie Teo at [Valerie.TEO@nac.gov.sg](mailto:Valerie.TEO@nac.gov.sg).

do not have access to an IRB and would like to gain approval through a peer review, please get in touch with NAC.

- All data generated from this body of research is considered shared intellectual property between the appointed researcher or organisation that generates it and the NAC. Based on the principles of mutual benefit and mutual respect, as well as the condition that one must recognise and acknowledge the contribution of the other, both researcher or organisation and NAC can make use of the research data and all relevant research findings freely in academic and professional publications, agency and institutional dissemination, local and international conference presentations, as well as sharing through press and media.
- If the research is undertaken by more than one organisation and/or other project partners, the basis of collaboration between the organisations, including ownership of intellectual property and rights to exploitation, is expected to be set out in a formal collaboration agreement. It is the responsibility of the research organisations to put such an agreement in place before the research begins. The terms of collaboration agreements must not conflict with the NAC's terms and conditions.

## STAMFORD ARTS CENTRE

Stamford Arts Centre (SAC) is located within the neighbourhood of the Arts Heritage District and Waterloo Arts Belt. It is envisioned as a **vibrant** and **energetic** arts centre focused on bringing the **traditional arts closer to the community**, supporting **content creation** and **artistic collaborations**, and the use of **digital technology**. Besides being a space for the arts, the Residency will support the role of the Centre in connecting communities, and bringing to life the shared experiences and memories of the residents and spaces in the locale.

SAC comprises of three blocks of building connected with a walkway on the second storey. The blocks are served by two lifts allowing easy accessibility throughout the Centre. The Centre comprises a multi-purpose hall (Black Box), an acoustically-treated music studio, artist residency studio and several shared facilities.

## DELIVERABLES

The awarded artist and researcher-in-residence are expected to commit 16 weeks, working towards the following outcomes:

1. Put up at least two public presentations on the research project at Stamford Arts Centre during the period of residency (presentation format may be subject to the prevailing Safe Management Measures. The format of the presentations should be discussed and agreed upon with NAC prior to implementation<sup>2</sup>).
2. Public presentations should be recorded and transcribed through digital means to facilitate further dissemination.
3. Documentation of development process with monthly updates.
4. A Post-Residency Report and Financial Report, submitted within 2 months of the Residency's completion.

NAC reserves the right to review, withdraw or withhold any funding and support in full or in part if any of the deliverables are not met.

---

<sup>2</sup> The format and topic of the discussions must be submitted at least 2 weeks in advance for NAC's approval.

## RESIDENCY PACKAGE

1. A grant of **up to** S\$ 20,000<sup>3</sup> covering the artist and researcher-in-residences' honorarium, research and other relevant costs associated with the Residency; and
2. A rent-free (utilities included) studio space fitted with air-con and lights<sup>4</sup>

## ELIGIBILITY

### Who may apply?

- Only Singaporeans or Permanent Residents of Singapore may apply.
- Only joint applications between academics/researchers and artists will be considered.
- Co-applicants who are artists must have at least 4 years of relevant arts practice.
- Co-applicants who are academics/researchers should be affiliated to a research institution or institute of higher learning. Independent researchers should provide a referee or document of support outlining his/ her research experience and achievements from relevant sources or institutions, where applicable.

### Who may not apply?

- Project proposals that:
  - a. Are part of school curriculum or requirements (e.g. PhD dissertation, school coursework)
  - b. Do not have a clear traditional arts focus
  - c. Do not have a clear research component
  - d. Are not intended for public consumption
  - e. Are not carried out in English as the main medium for communication
- Applicants with pending/ outstanding:
  - a. Evaluation reports on the use of previous grants from NAC
  - b. Debts with NAC (you would be eligible to apply once you have cleared outstanding debts)

### Application Deadlines

The table below lists the key application deadlines:

RESIDENCY PERIOD	APPLY BY	NOTIFIED BY
16-week period within 1 April 2022 – 30 September 2022	31 January 2022	15 March 2022

All applications must be submitted by 2359h, **31 January 2022**. You can submit your applications early, in advance of the application window. Incomplete and/or late applications will not be considered.

<sup>3</sup> For grants of \$10,000 and above, the artist and researcher-in-residence will also need to submit Statement of Accounts certified by an accountant registered with the Institute of Singapore Chartered Accountants (ISCA) or equivalent international body. Accounting fees for this statement can be budgeted for in your application.

<sup>4</sup> Please refer to **Appendix A** for studio space specifications

## HOW ARE APPLICATIONS ASSESSED

### How will your application be assessed?

Our assessment will be guided by the following criteria:

- Impact of the research on the Singapore arts scene.
- Sound research objectives and methodology.
- The co-applicants' track records and capacity to execute the project.
- Dissemination of research findings and articulation of long-term engagement plans.
- Demonstration of good project management through the proposal – budget, feasibility of plans and proposed use of space.

### **A note on Funding Guidelines**

While we celebrate diversity of expression and open, balanced dialogue in the arts, as a statutory body disbursing public funds in line with Government policies, NAC has to prioritise funding to proposals which do not:

- Advocate or lobby for lifestyles seen as objectionable by the general public;
- Denigrate or debase a person, group or class of individuals on the basis of race or religion, or serve to create conflict or misunderstanding in our multicultural and multi-religious society;
- Undermine the authority or legitimacy of the government and public institutions, or threaten the nation's security or stability.

## TERMS AND CONDITIONS OF PARTICIPATION

By submission of the Residency application form, the co-applicants agree to all of the abovementioned guidelines as well as the following terms and conditions:

1. The National Arts Council reserves the right to record all or part of the proceedings of the Residency and related activities for broadcast and promotional purposes without payment to the applicants or the applicants' consent. National Arts Council retains all rights to the recorded materials.
2. Any applicant who knowingly gives inaccurate or misleading information will be disqualified.
3. In case of any disputes, the National Arts Council's decision shall be final and no discussion or correspondence will be entertained.
4. The National Arts Council reserves the right to amend the rules and terms and conditions of the Residency.

**Appendix A – Studio specifications**

FOR TRADITIONAL ARTS RESEARCH RESIDENCY

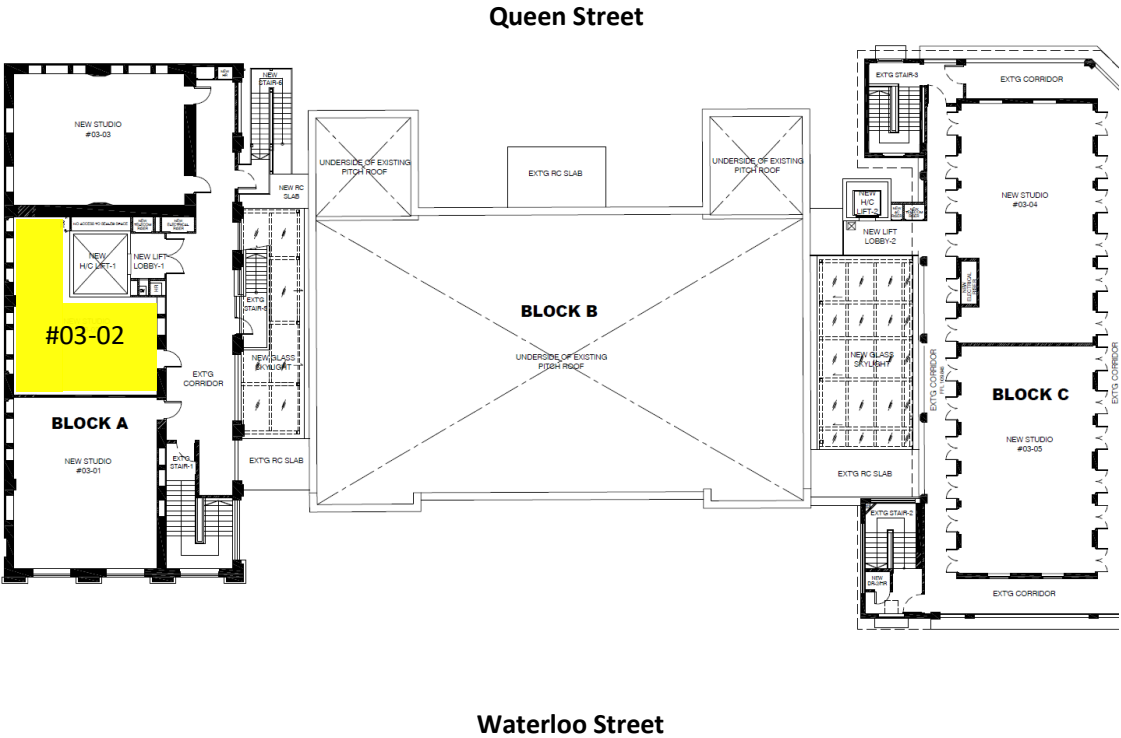

Unit	#03-02
Area	581 sqf / 54 sqm
Utilities	Air-con and lights
Opening hours	9am – 10pm, daily