



NATIONAL ARTS COUNCIL  
SINGAPORE

## OPEN CALL FOR 2026 TRADITIONAL ARTS RESIDENCY AT STAMFORD ARTS CENTRE

### ABOUT TRADITIONAL ARTS RESIDENCY

In its sixth edition, the Traditional Arts (TA) Residency supports the incubation of new and innovative content with a traditional performing arts focus. It aims to provide a more structured training to equip TA artists with capabilities to propel their artmaking to the global arena and create opportunities for artists to establish networks with key players in the local arts scene and beyond.

The residency invites individuals, groups or collectives to incubate a **new intercultural and/or cross-disciplinary work with a strong Traditional Arts focus, with plans for international dissemination**. The residency spans 4 to 6 months, from **October 2026 to March 2027**<sup>1</sup>. The residency should culminate in a work-in-progress showcase by the end of the residency period.

For this edition, selected artists-in-residence will receive **funding, access to shared working space**<sup>2</sup>, as well as **support from an overseas mentor, Long Play Lab (LPL)**. LPL will oversee and provide tailored feedback on the artistic development of the projects, as well as conduct a 6-module curriculum for the artists-in-residence. Artists-in-residence will be able to leverage on LPL's extensive networks and experience in the cultural and creative industries and learn how to pitch their works on the global arena.

In addition, there may be opportunities for artists-in-residence to tap on the network of traditional arts groups housed in Stamford Arts Centre (SAC) and seed exchanges with these arts groups. Situated in the vibrant and dynamic district of the Waterloo Arts Belt, this residency also offers proximity to the rich repository of resources in the National Library and arts institutions like the Nanyang Academy of Fine Arts and Lasalle College of Arts.

### THE LONG PLAY LAB TEAM

Helmed by Topi Lehtipuu and Ivan Ludlow, [Long Play Lab \(LPL\)](#) is a strategic cultural think tank that designs training and strategy programmes for cultural institutions and government departments. The team is interested in cross-cultural dialogue and multi-disciplinary approaches to artistic creation and the adaptability and relevance of traditional art forms. Both directors have a wealth of experience in performing, programming and producing, as well as an extensive international network of cultural executives and practitioners.

---

<sup>1</sup> Applicants can propose a suitable timeline and determine their project duration (4 to 6 months) within the available residency period between October 2026 to March 2027. The schedule of the residency will be designed in a tailor-made fashion according to the needs of each project, in close consultation with the mentor Long Play Lab (LPL).

<sup>2</sup> Awarded artists-in-residence will not have full access to the working space for the entire duration of the residency, as the space will be co-shared amongst all groups. Estimated number of hours of studio access will be worked out after Letter of Offer acceptance.



Topi enjoys a career as an artistic consultant, festival director and curator, and is also a classical singer of international renown. He was the director of the Helsinki Festival, the largest multi-arts festival in the Nordic countries, where he commissioned and curated new works of all artistic disciplines. Topi has overseen a reorganisation of the various festivals in Helsinki and has advised a wide range of cultural organisations, including one of the world's top music universities, Sibelius Academy.



Ivan has long combined his international performance career with one as an artistic director (Opera Faber Festival in Portugal), project producer, teacher and cultural advisor. His recent work focused on the conception of multi-arts educational institutions, showcases for performing arts projects and the development of new approaches to distribution and remuneration in the music industry. Ivan's film production company, New Studios, uses the artistry of today's stage performers to tell extraordinary stories on all aspects of culture and performance through cinematographic content.

## ELIGIBILITY

The project needs to have a **strong Traditional Arts focus**. The lead applicant of the project can be:

- (1) An **arts practitioner primarily practising Traditional Arts**, with at least 2 years of relevant experience working in the arts; or
- (2) An **arts practitioner with track record of integrating Traditional Arts into their practice and creation**, with at least 2 years of relevant experience working in the arts.

The core artistic team needs to have at least 1 Traditional Arts practitioner, and collaborator(s) may be from various artistic disciplines/ practices/ fields.

### Who may apply?

- Individuals** who are Singapore Citizens or Permanent Residents (PR); or
- Organisations** that are either registered with ACRA (including Non-Profit / Non-Government / Community-based organisations / sole proprietorship / limited liability partnership (LLP) / Company Limited by Guarantee (CLG) / Private Limited Company) or a society registered with the Registry of Societies at the time of application; or
- Informal groups or collectives** in which at least half of the members are Singapore Citizens or PR<sup>3</sup>. The lead applicant will have to undertake legal and financial responsibility on behalf of the collective.

### Who may not apply?

- If your group or collective is constituted for non-secular purposes.
- If you and/or any member of your collective have outstanding evaluation reports or deliverables from previous NAC grants, at the time of this application.
- If you and/or any member of your collective have outstanding debts with the NAC at the time of this application.
- If you are a student.

---

<sup>3</sup> For example, for a collective with four members, three members must be Singapore citizens or PR.

## A note on Funding Guidelines

While we celebrate diversity of expression and open, balanced dialogue in the arts, as a statutory body disbursing public funds in line with Government policies, NAC will prioritise funding to proposals which do not:

- Advocate or lobby for lifestyles seen as objectionable by the general public;
- Denigrate or debase a person, group or class of individuals on the basis of race or religion, or serve to create conflict or misunderstanding in our multicultural and multi-religious society;
- Undermine the authority or legitimacy of the government and public institutions or threaten the nation's security or stability.

## RESIDENCY PACKAGE

### What support is available per project?

1. A **grant of up to S\$30,000<sup>4</sup>**, which comprises support for:
  - a. Up to S\$20,000 covering the artist-in-residence and collaborator's honorarium, research and other relevant costs associated with the residency; and
  - b. Up to S\$10,000 for Project Showcase expenses;
2. **Mentorship guidance and support by Long Play Lab (LPL)**, with the following tentative schedule:
  - a. Long Play Lab will be available for in-person sessions at SAC for one week each month;
  - b. In the remaining time, the artist(s)-in-residence are to independently work on their projects at SAC (subject to availability), while being in contact with LPL remotely;
  - c. 1 scheduled break within the 4 to 6-month residency period;
  - d. Note: The mentoring sessions may be in the form of group sessions with all the artist(s)-in-residence or conducted separately, depending on the needs of the artists/projects. The schedule is tentative, and it will be subject to changes upon discussion with LPL after the Letter of Offer (LOO) acceptance;
3. A rent-free (utilities included) **SAC studio space** fitted with air-con and lights<sup>5</sup> for up to 6 months, shared amongst all the artist(s)-in-residence, subject to availability.

## KEY DELIVERABLES

Awarded artists-in-residence are expected to commit to the full duration of their residency, between October 2026 to March 2027, and achieve the following outcomes:

1. Develop a new work that is intercultural and/or cross-disciplinary in nature, with a strong Traditional Arts focus or is rooted in Traditional Arts practices;
2. Ensure 100% attendance for all mentorship/ curriculum sessions with LPL and any other subject specialist engaged by LPL, unless in the event of unforeseen circumstances (LPL and NAC to be notified in a timely manner and relevant documentation to be furnished);
3. Documentation of residency progress through email updates to NAC at the midpoint and three-quarters completion of the residency period;

---

<sup>4</sup> For grants of \$10,000 and above, the artist-in-residence will also need to submit Statement of Accounts certified by an accountant registered with the Institute of Singapore Chartered Accountants (ISCA) or equivalent international body. Accounting fees for this statement can be budgeted for in your application.

<sup>5</sup> Please refer to **Appendix A** for the SAC studio space specifications.

4. Present a work-in-progress (WIP) Showcase towards the end of the residency<sup>6</sup>, format to be determined according to the development stage of the work by the end of the residency;
5. Work closely with LPL to connect with an international festival/platform, to pitch the new work created through this residency; and
6. Submit a Post-Residency Report and Financial Report, submitted within 3 months of the Residency's completion.

NAC reserves the right to review, withdraw or withhold any funding and support in full or in part if any of the deliverables are not met.

## HOW ARE APPLICATIONS ASSESSED

Applications will be evaluated by both NAC and LPL. There will be a shortlisting process, and shortlisted candidates will be invited to attend an interview in August 2026. The final decision on the outcome of the application and funding will be made by NAC.

The assessment will be guided by the following criteria:

- Potential contribution to Traditional Arts practice**
  - Impact of project to development of the Traditional Arts form and scene
  - Ability to address a gap in the TA ecosystem
  - Impact of the project in development of the applicant's practice
- Artistic strength of the proposal and potential for international markets**
  - Potential to push artistic boundaries and strong cross-cultural elements
  - Scalability of project for different platforms and audiences
  - Potential international appeal of work and plans for international dissemination
- Artistic track record and project management**
  - Track record of both the applicant and core artistic team/ collaborators
  - Capacity and commitment to execute the project

## SUBMISSION

### When and how to submit an application?

All applications must be submitted by **15 July 2026, Wednesday (11.59pm)**. Incomplete and/or late applications will not be considered.

RESIDENCY PERIOD	APPLY BY	NOTIFIED BY
4 to 6 months within period from 1 October 2026 to 31 March 2027	15 July 2026	16 September 2026

A **full** application includes the following:

1. Completed application form ([Annex A](#))
2. Budget Form ([Annex B](#))
3. Curriculum Vitae of main applicant and all collaborators

---

<sup>6</sup> Finalised details for Project Showcase should be submitted to NAC latest 1 month before the end of the residency.

4. Two samples of past works by applicant *or* link to portfolio
5. *Optional: Any other supporting documents, which can give us a better understanding of your current body of works*

#### TERMS AND CONDITIONS OF PARTICIPATION

By submission of the Residency application form, the applicant agrees to all of the abovementioned guidelines as well as the following terms and conditions:

1. The National Arts Council reserves the right to record all or part of the proceedings of the Residency and related activities for broadcast and promotional purposes without payment to the applicants or the applicants' consent. National Arts Council retains all rights to the recorded materials.
2. Any applicant who knowingly gives inaccurate or misleading information will be disqualified.
3. In case of any disputes, the National Arts Council's decision shall be final and no discussion or correspondence will be entertained.
4. The National Arts Council reserves the right to amend the rules and terms and conditions of the Residency at any time.

**Appendix A: About Stamford Arts Centre**

Stamford Arts Centre (SAC) is located within the neighbourhood of the Arts Heritage District and Waterloo Arts Belt. It is envisioned as a vibrant and energetic arts centre focused on bringing the traditional arts closer to the community, supporting content creation and artistic collaborations, and the use of digital technology. Besides being a space for the arts, the Residency will support the role of the Centre in connecting communities and bringing to life the shared experiences and memories of the residents and spaces in the locale.

SAC comprises of three blocks of building connected with a walkway on the second storey. The blocks are served by two lifts allowing easy accessibility throughout the Centre. The Centre comprises a multi-purpose hall (Black Box), an acoustically treated music studio, artist residency studio and several shared facilities.

**Appendix B – SAC Studio Specifications**

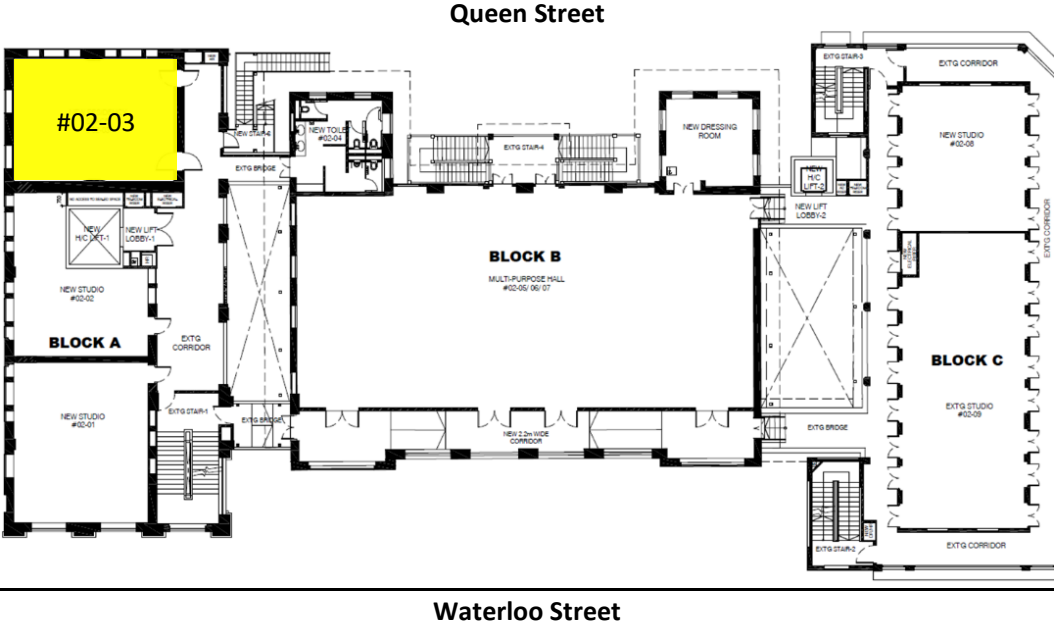

Unit	#02-03
Area	710 sqf / 66 sqm
Utilities	Air-con, lights, acoustically treated walls and raised carpeted floor
Opening hours	7am – 11pm, daily